

2000 I-30 E
Greenville, TX 75402

Wednesday, September 6, 2023

Office of Hopkins County Judge
PO Box 288
Sulphur Springs TX 75483

Farmers Electric Cooperative Member: Gregory Graham
Service Order Number: 2023015270

Greetings:

Farmers Electric Cooperative, Inc. is requesting permission to construct electrical power distribution facilities which will cross County Road 4707 which is locate in Hopkins County, Texas.

Site location map and construction sketches are attached. The construction sketch details the proposed work. Choose an item.

If you have any questions, please contact me at any time.

Sincerely,

Randall Osornio
Project Coordinator
rosornio@farmerselectric.coop
Phone 903-513-9565

Submitted by Kim Harry
kharry@farmerselectric.coop
Engineering Coordinator

Enclosures

County Approval Section:

Approved: Denied:

Authorized Signature: *Joe Lewis*

Date: 9-20-23

37

County Road 4707

County Road 4708

County Road 4707

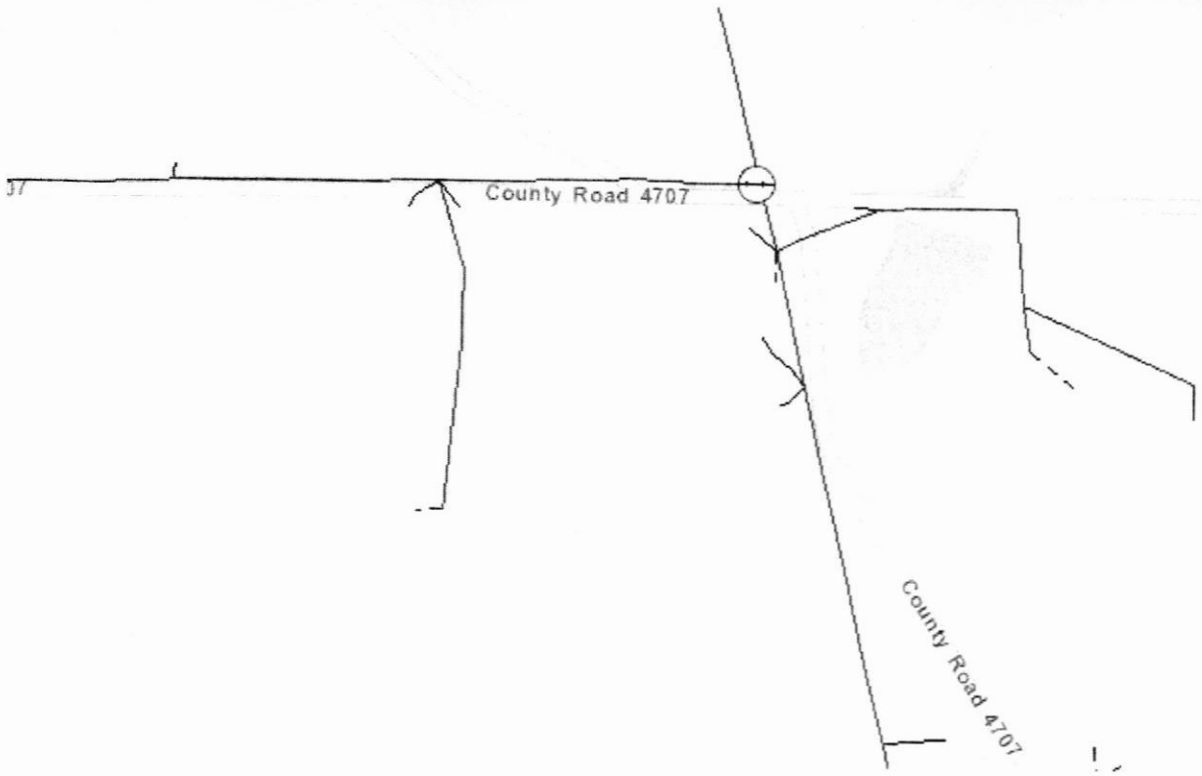

4 ACSR

CR 4707

1/0 ACSR

Proposed Driveway

Proposed House location

P1 = 4415' from CR 4708 →

Protective Device:
OCR-111129 →

3

4

